



Bethnal Green Road, London, E2

BUTLER & STAG



Smart and spacious three bedroom apartment set within this popular mansion block in buzzy Bethnal Green.



- Three Double Bedrooms
- Lift Access and Concierge Service
- Surrounded by Shops and Amenities
- Furnished
- Third Floor Apartment
- Moments from Bethnal Green Tube Station
- Ideal for Three Professional Sharers
- Available from 2nd August 2025

Located just moments from Bethnal Green underground station, this property is ideal for three sharing professionals. A vast array of shops and amenities are on your doorstep, as well as the popular hotspots of Shoreditch, Brick Lane, Columbia Road and Victoria Park.

Comprising of a generous reception space which is semi open-plan to a modern fitted kitchen, all three bedrooms are doubles with wardrobes and the condition is well-presented throughout. This third floor apartment is completed by a main bathroom, additional WC and hallway storage.

The development itself enjoys a concierge service, lift access and art-deco communal areas.

Offered furnished and available from 2nd August.

EPC Rating B
Council Tax Band D





Bethnal Green Road

Approx. Gross Internal Area 84 Sq M (906 Sq Ft)

BUTLER & STAG

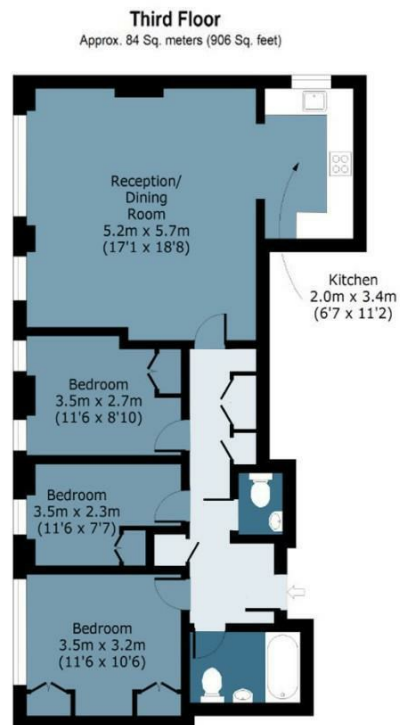

Measurements are approximate and for illustration purposes only. While we do not doubt the accuracy and completeness, we advise you conduct a careful independent assessment of the property to determine monetary value.
© @modephoto.uk www.modephoto.co.uk

IMPORTANT NOTICE - These particulars have been prepared in good faith and they are not intended to constitute part of an offer or contract. We have not performed a structural survey on this property and the services, appliances and specific fittings have not been tested. All photographs, measurements, floor plans and distances referred to are given as a guide and should not be relied upon.

BUTLER & STAG

☎ 020 8102 1236

🏠 508 Roman Road, Bow, London, E3 5LU

✉ bow@butlerandstag.com

www.butlerandstag.uk